

# AUTO CUT S 105P



CE EN60974-7

CODE	↔	
------	---	--

PA1682	6 m	19.7'	CENTRAL
--------	-----	-------	---------

PA1684	6 m	19.7'	1/4 GAS
--------	-----	-------	---------

TECHNICAL DATA		
----------------	--	--

<b>NO HF</b>		
	0,9 kg	1.98 lb
<b>V PEAK</b>	500	
	4 bar	
	180 l/min	
<b>X 60%</b>	100A	
<b>X 100%</b>	70A	
	25÷30 mm	

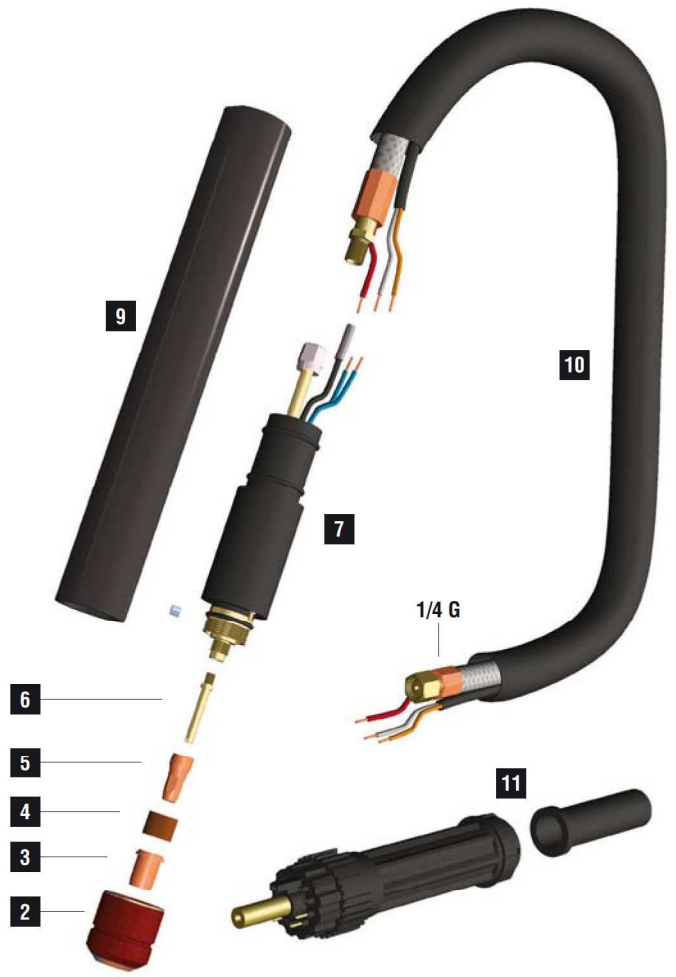
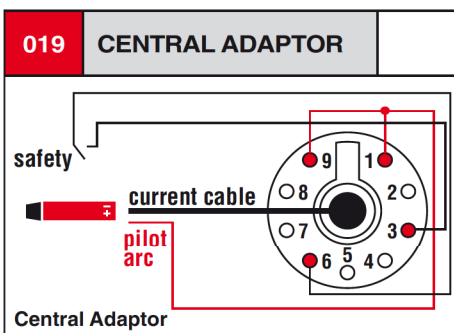
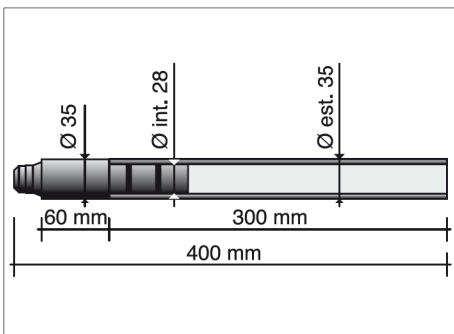

	CODE		Ø		CONTACT		REF			
2	PC0118		long life			39,5 mm			4	
3	PD0119-10		50 A	1,0 mm	.040"	18,7 mm			-	10
3	PD0119-12		70 A	1,2 mm	.045"	18,7 mm			-	10
3	PD0119-14		100 A	1,4 mm	.052"	18,7 mm			-	10
4	PF0112		plasma diffuser						-	2
5	CV0080									1
5	PR0117		plasma electrode			23,7 mm				10
6	FH0647									10

	CODE	
7	EA0223	10
7	PF0137	plasma torch head 1
7	PT0030	repair kit 1
9	TP0061	1
10	PH0132	6 m - 1/4 G 1

	CODE	
10	PH0207	power cable 6 m - 1/4 G 1
10	QB0097	cover (mt) 100
11	CY0002	cable support 1
11	FY0023	central adaptor 1

STANDARD

CONTACT SHORT

CONTACT LONG